



GOLF

In Such Wise



by J. Calvin Elder P

GOLF ~ In Such Wise

Copyright 1981 J. Calvin Elder

ON THE HIGH RISE

A golf league found considerable dissatisfaction in scheduling their Saturday tee-offs. Delays were so frequent that membership began to decline. Leaders of the organization met to resolve the league's problem. The decision was made to purchase land and build a golf course, exclusively for the league's use. Money was raised, chiefly among the enduring, faithful members.

Initially, money was paid down on a 110 acre, nine hole golfing area in Murrysville, Pa. 35,000 was the price of this property. Immediately, the price for adjacent lands became \$1,000 per acre when the owners discovered a golfing organization wanted the land to increase the number of golfing holes to eighteen. Luckily, however, the money initially paid for this land was returned by a kindly lady, Mrs. Remaley, when splendid acreage for an eighteen hole golf course became available. This favor to the Original Willowbrook Ten, with their dream of building a splendid golf course, was one of the things that made Willowbrook Country Club possible.

Standing on the high rise that later became number ten green approach, five members of the golf league, and the salesman, overlooked the expansive farm in consideration. A beautiful view lay off to the North. Water sources were apparent, although the land was predominately level, and seemingly as high as the distant mountain ridges.

The salesman said, "You could land an airplane on this farm."

The five men, tempting providence, then and there agreed to secure the ground for eighteen hole Willowbrook Country Club.

Personal:

This material in development must be affirmed and must be acceptable to companies or persons named, prior to general publication.

PRACTICED BODY ENGLISH

NEAR THE OLD BARN

Only two roads ran into and through the farm that became Willowbrook Country Club. The grassed over, dirt lanes formed a T near the old barn. Here, hopeful of visitors' attention for keeping and getting new members, the first development was laid out. It was number eleven green that was placed at the so-called "Cross Roads", the two, dirt, country lanes. "Cross Roads", used by the club president, was an overstatement, if ever one was made.

On my first visit, alone to the great expanse of ground comprising Willowbrook, this first development, number eleven green, I surely found; and its appraisal sufficed to continue my monthly \$10.00 payments as a charter member. These farm lanes were later improved, the one continuing to the club house being macadamized by local government. The "Cross Roads" and other resourceful purposing by the president helped to bring beautiful cwc through a recession and other problem times intact.

PLANNING

In the initial arrangements made to purchase the grounds, 213 acres, for Willowbrook Country Club, the committee first engaged the associated real estate involvement. This included a preliminary amount of money that the fellows did not wish to lose. They then reviewed the situation with the farmer who owned the property. An agreement was reached where, following a six month waiting period, the committee could deal directly with the farmer and eliminate the transfer fee, the time allotment of the real estate transaction being expired. It is said that during this time, the farmer, himself, borrowed money on the property and in effect in his payments, paid part of the interest on the property loan. The owner of the property was Mark Medice.

The purchase of the property for \$50,000 was arranged legally, with the payments to be made at stipulated times. The originator, the initial planner in this golf interest was Nelson A. McAfee. The Original Willowbrook Ten, who each placed \$50.00 in the purse for down payment money were:

William Anderson	Albert Beswick	George F. McGlumphy
James C. Benninghoff	Theodore Clinger	James McMahan
Raymond T. Benninghoff	Nelson A. McAfee	William A. Ragan
		Raphael Weakland

The Steel Run Land Company was incorporated on Aug. 15, 1956.

PRACTICED BODY ENGLISH



I SHOULD NOT OUGHT TO HAVE HIT IT LIKE THAT !!



GET OVER, BALL, OUT OVER! LEFT, CURVE IT LEFT! GO YOU LITTLE ROUND - !!



IN, BACK IN! NOW, RIGHT, BEND IT RIGHT !! QUIT ROLLIN' YOU, YOU DIMPLED, WHITE - !!

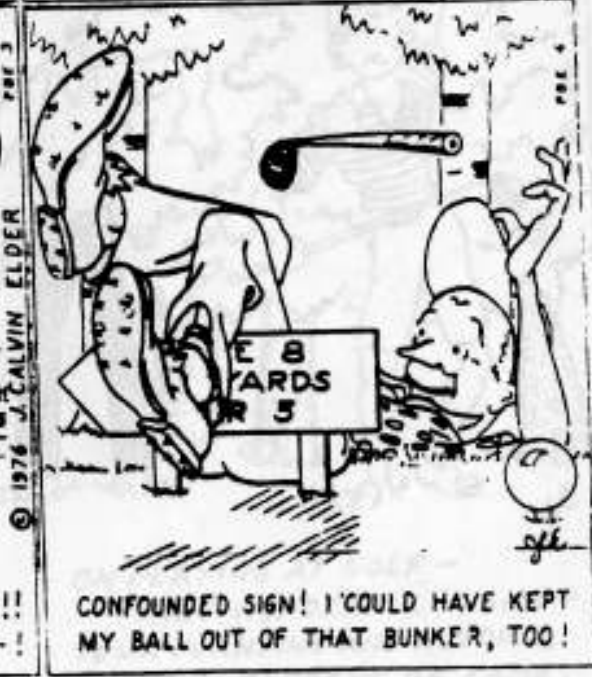

CONFOUNDED SIGN! I COULD HAVE KEPT MY BALL OUT OF THAT BUNKER, TOO!

YOUR POUNDS AND HUBBARD
HELPS IN THE JUNGLE
THAT'S FINE OLD CHOPES
SEEN NOT TO GET DONE

PROSPECTUS

A prospectus was made for the future Willowbrook Country Club. In booklet form a fine proviso was made for the employees of Union Switch & Signal Co. and Westinghouse Air Brake Co. Membership in the club was limited to employees of these two associated companies. Membership was available by working out a bond at the site at the rate of one dollar per hour. Family membership was featured. Areas of the grounds were reserved for skeet shoot, rifle range, bow and arrow, soft ball, base ball, tennis, swimming---sites were laid out in the planning for all of these sports facilities. A plan of the country club made in base relief was exhibited at the two companies. All parts of the golf club were featured in detail, including the barn and fine home on the site. The purchase price of the property was \$50,000. Shortly, with this outlay of sports facilities so splendidly portrayed, the story of Willowbrook Country Club was featured on the front page of second section Pittsburgh Press; and the entire membership availability of four hundred bonds was sold out.

WHAT A BLOW



OF ONE'S OWN ACCORD

OUR HUSBANDS OUT THERE HIT

THE SITE

The acreage was farm land, generally level but with some hills and valleys. A pond adjacent another farm became the lake of number three fairway. A decrepit saw mill was located at the present site of the club house. What is now number three fairway was in good part a dense woods. A small stream between the grounds and an adjacent farm directed water to a location in woods where a dam was built for the tees and greens water supply.

A splendid view overlooks farm land, northward, and includes the hangar of a sky diving organization. The distant mountain ranges appear to be at a level with the Willowbrook fairways. Willowbrook Country Club lies along Oklahoma Road between the towns of Apollo and New Kensington, Pa.

EQUITY

The Charter equity - Willowbrook Country Club - began at \$480, that is, for payment of \$10.00 a month for four years. This equity value was refunded upon resignation, until the roof leaked. Improperly constructed by contract, the roof needed recovered; and the equity refund money allotment was so used. Refunds were then made only at death, to survivors. A building addition was made to cwc comprising a new room with bar and professional golfer shop. This beautifully decorated bar room and much needed Pro. Shop brought the equity of cwc to \$580.00.

STARTERS

With the fine planning and provisions for Willowbrook Country Club, several companies lent bulldozers, trucks, and machinery to assist the planners in their completion of this splendid golfing facility. Tons of sand, gravel and humus was purchased. Willowbrook became a-building. Early in the construction a recession occurred and bond holders were laid off from their jobs. It became difficult for the planners to collect the necessary money to continue the work on schedule. There came a time when \$10,000 was required to make payments on bills and the loan for the property. One of the "Ten" signed a Credit Union note for this amount, with forty nine persons as cosignatory. Doing this, these people made the required money available, as they worked at the site or continued in their regular monthly payments toward their bond. Another time \$5,000 was immediately required and twenty five persons supplied the funding in the same fashion. Through this recession period, also, many cancelled their membership. The committee compensated by going outside the two companies and soliciting memberships in other businesses. Therefore, no longer was Willowbrook associated only with the two parent companies.

OF ONE'S OWN ACCORD

OUR HUSBANDS OUT THERE HIT THE BALL, THEN CRINGE AND CLUB THE GROUND. GOLF IS FUNNY.

YOUR GUYS ARE THE CLOWNS, DOLLS, 'TAINT THE GAME.



MIGHTY 400

On the installment plan, calling themselves the "Mighty 400", employees of the Union Switch & Signal, Swissvale, and Westinghouse Air Brake, Wilmerding, teamed together to build themselves a golf club. Believed to be the first employee-owned country club in the nation, they worked to have it in use by the Spring of 1957. As a do-it-yourself country club, it was financed and built by clerks, engineers, laborers, craftsmen, factory workers and supervisors of these two associated railroad supply industries. With the 400's work done, these averagemen would own shares in one of the world's most unusual golf clubs. While it was strictly an employee's venture, the two Pennsylvania companies encouraged the project and gave counsel.

To hire experts to build the country club would have meant using their limited financial reserves. Alternately, the people decided to design the place themselves. Everybody helped, in planning, surveying, researching golf course literature, grounds care in fertilization, and all the involvements of a golf course. The National Golf Foundation offered its services. A golf course architect looked over the plans for the golf course and declared that the "400" had done a very good job. The architect made but a few minor changes before the first spade was turned on the layout.

SOME OF THE PEOPLE

It was a challenge to turn wheat fields into a fine golf course. Officers guiding the project were Mr. William A. Ragan, president, and R. A. Weakland, vice president, a Switch time study man. John Kashurba, 2nd vice president, was a production expediter at Air Brake. Nelson A. McAfee, secretary treasurer, was a materials engineer at Switch. Mr. Ragan was superintendent, manufacturing at the Switch.

Factory workers had to become contractors and field workers. A Penn Township excavating contractor, A. D. Weaver, volunteered to teach the men how to handle big earth moving machines.

Smiling from behind the wheel of a high lift, Charles Barr, a laborer at Switch said, "I never thought I'd run one of these things! I didn't think I'd ever belong to a country club either."

The board of directors included: Albert Beswick, works manager; George McGlumphy, engineer; William J. Anderson, accountant, all of the Switch; John H. Creighton, chief clerk and Donald R. Rhodes, production supervisor at the Air Brake. Special assistants from the two companies were Dave Brown, James Benninghoff, John F. Vactor and Russell Plues.

THE LADIES' TEE

ONE FALSE STEP AND THEY
CAN FALL OVER THAT CLIFF



SHIPSHAPING

Willowbrook Country Club was known as "the poor man's golf club". The 350, or so, charter members were very slow in any assessment payment, until the equity was equivalently raised. Seemingly at once then the money flowed in from the members, like frigates with crowded sails. A dining room, elevated from the dance floor was added, large enough to house two hundred diners. With great windows, the well decorated room has several full arches overlooking the dance floor. A corresponding addition to the charter equity raised it to \$680.00.

58 CARTS

Willowbrook Country Club members were permitted to house their own power golf carts in the old, bat filled barn, at a fee. The barn was built of great, wonderously joined, wooden beams. At a later date, the old barn was re-sided with hard woods forrested off the club property. As restored to its original condition, the barn has become a country landmark.

The directors resolved to build a new power golf cart storage building, having a new, Professional Golfer's Shop and golf club storage room. With fifty eight members initially having cart storage, and paying \$100.00 per year, the building was built and paid for by storage fees. There was no additional charter equity increase.

With the new cart storage building underway, eight golfers and their wives wanted to buy used, power golf carts. A local company had some, recently exchanged for new ones. In their fadeout a guarantee was their splendor.

ASSIGNMENTS

With the departure of Nelson A. McAfee, the initiative, the compelling interest, the very completion of Willowbrook Country Club lay in the hands of William A. Ragan. Capably, creatively, resourcefully, Bill with the help of the "Ten" continued with the work to complete cwc.

In the construction of Willowbrook different job assignments were made. The general leveling work, the building of greens and tees, fairways and rough layouts, and the water system for watering greens, tees and their approaches—all these assignments were made.

Bill Ragan got the assignment of the watering system for the greens and tees. A damn was built, ditches were dug, pipe was laid, a pumping system was built. The facility to water each green and tee was completed. Bill then surveyed the remainder of the work to be done. At the rate things were being completed, it would be another year or two before the golf course could be ready for play. Bill then stepped in and took on these assignments, himself. In August of that year, Bill had the work completed. The grass was growing!

FORTY FIVE PERCENT

Through the year of 1957, a dream rapidly became a reality. The two hundred and thirteen acres of farmland, pasture and woodland got a "new look". With the golf course nearly forty five percent completed, the following estimated figures were compiled. About fifteen more months of work were estimated for Willowbrook's completion.

7000	Man hours of labor
8000	Miles haulage soil, sand, gravel
4000	Cubic yards fill
2000	Gallons gasoline
1000	Gallons diesel fuel
100	Tons lime
35	Tons fertilizer
9000	Pounds grass seed
500	Tons sand
300	Cubic yards humus
12	Inches of seed bed atop greens and tees drainage area
6000	Square feet average greens area
6550	Yard length golf course

Many hundreds of trees were removed. Sixty acres of hay, wheat and corn was mowed. Seven hundred soil samples were taken for analysis. Most fairway areas were disced three times. Fifty tons of stones were hand picked and reused for aggregate and road beds.

DOINGS

The work at Willowbrook was done, generally, by persons working out their bond at one dollar for each hour. One job required the laying of gas pipe from number twelve fairway up hill to the club house. Three inch pipe need by used for this gas line. The pipe was shipped to a location for threading, in mostly twenty-six foot lengths. The body of the truck for moving this pipe to the club location was too short to carry the pipe. Accordingly, a rack was built on the truck body, so that the pipe could, as well, be supported on the truck's cab roof. The pipe was loaded on the rack for the trip to the club site. Although carrying a load with a high center of gravity, the truck was successfully driven to Willowbrook with only one occasion for a warning, stop signal, this on a curve with the truck swaying severely.

Four fellows were available to lay this three inch pipe about six hundred yards, from number twelve fairway location to the club house. William Ragan, bossing the job, was informed by the gas company that their people would not lay the pipe. He was also informed that it would take at least eight men to lay the three inch pipe. With the necessary six foot long pipe wrench, and with three other fellows to help, Bill began this hard job. Along about existing number eleven green, 100 yards along in the job, two of the fellows told Bill that they could not possibly continue the work as they were too tired. They departed. A foresome in golf approached the green, nine holes being then played. Bill asked for help. Two golfers offered their help, allowing Bill to finally finish the job. Dead tired, the four fellows completed laying the three inch pipe after dark.

OPPORTUNITY IS TRANSIENT



HAPPENINGS IN cWc CONSTRUCTION

One of the fellows was driving a bulldozer in leveling work. The dozer was moving at the usual rate of speed when it struck a great rock. The driver was thrown to the high side of the bulldozer. The machine was slowed by the heft of the great rock and the driver was able to quickly remove himself from the path of the machine. He then climbed back aboard of the bulldozer and continued with his work.

Larry McCormick, Willowbrook's first Secretary, was the first person to cut grass on number eleven fairway. This rough, near the ladies' tee high on the side of the hill, has an extreme slope. Larry proceeded over this slant driving the tractor pulling the mowers. When he reached the extreme slope, Larry sat well up on the high side of the machine's seat, ready to jump off over the high side of the tractor, if it should tip over.

Several fellows were working near the barn. They directed the dumping of a truck load of gravel. It was cold. When the gravel was dumped, many white bellied kangaroo mice were seen mixed in with the gravel. They lay still. However, lying in the sun and with air to breathe the mice began to move. Soon, a dozen little, white bellied kangaroo mice were dancing about the gravel pile. The fellows watched with great interest as these little creatures dissappeared into the near-by high grass.

CLUB HOUSE

In August of 1959, a meeting was had comprising one hundred thirty eight members to discuss and vote upon the building of the club house. The cost for an average, small size club house was estimated at \$60,000. The membership voted to borrow \$65,000 at 5½% interest for ten years. Estimates included monthly interest and principal payments of \$680.00, or \$8,160.00 yearly. The estimated yearly income at 500 members was \$50,000. The men's locker room would contain 400 lockers, the ladies, 80.

LOST BALL

Willowbrook Country Club's tees and greens were watered. The fairways, however, acquired their moisture from natural causes. Consequently, many dry summers caused handicaps to decrease rapidly, as dry grounds allowed free ball roll to reduce strokes. With rain, again, handicaps would increase. The directors resolved to eliminate this discrepancy by providing for automatically watering the fairways. Again, the money was requested by assessment, however, it became available, only, when the equity was raises to \$950.

A contractor for the Willowbrook fairways watering system dug the required ditches right down the middle of the fairways. He laid thousands of feet of blue, plastic pipe and many, many wires in the ditches. Begun in the late fall of 1977, the ditches were still in roughed-up condition in June of 1978. Handicaps certainly grew in numbers during this period, since the rough ditches with rows of turned up dirt and adjacent uncut grass impeded golf ball roll. In the first three, 1978 major golf events of cWc, that is, "Your Own Foursome", the "Derby" and "Captain's Golf", players lost balls in the middle of fairways in the ditches and the high grass along them.

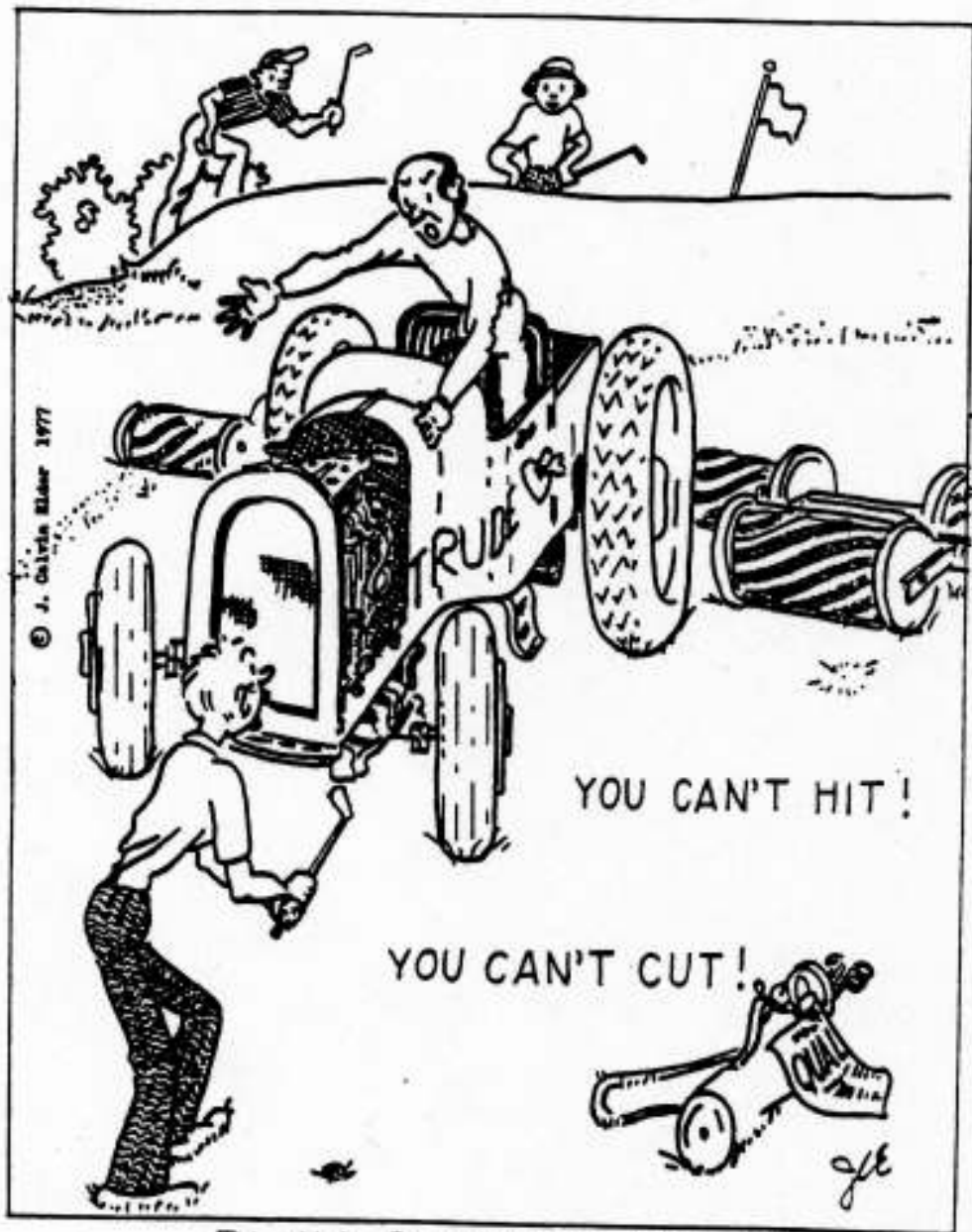

© J. Calista Blaser 1977

YOU CAN'T HIT!

YOU CAN'T CUT!

PLAY SUMMER RULES

"DUTCH" TREATS

The yearly President's Cup Match is most interesting and hotly contested. The President's Cup is a a twosome encounter. My first, with half the difference in handicaps gave me a four point advantage. Play was back and forth in favor in match scoring. On number 15 green, it was 'touch and go' between myself and my opponent, as well as with our scoring, accompanying twosome. The question was, just who's ball was in the sand trap. It could not, of course, have been either scorer's ball. This was finally resolved as a slice hitter strode up from number 17 fairway and claimed that ball. I lost this match.

Another encounter for the President's Cup gave me six strokes. I won this match, seeing my opponent blast his balls into pine tree nurseries, traps, pastures, the woods, high grass rough and the apple orchard. A distance shooter, he had no notion that day of final ball lie. Another play-off match between "Dutch", a great humorist and his opponent, a scratch golf player, drew much club attention. "Dutch", upon arrival to play, first, took a cart to number two tee to see where the white tee markers were placed. Not being a long-ball driver and seeing that the tee markers were placed well back toward the woods, "Dutch" came back to the club house. He declared that his brother was sick, and promptly departed. "Dutch" won his match, as rescheduled, the white tee markers being placed well forward that day.

"OUTSIDERS"

William A. Ragan was the first President of Willowbrook Country Club as a splendidly completed golf course. The club was owned, in effect, by employees of Union Switch and Signal Co. and Westinghouse Airbrake Company. The members of the Board of Directors were elected by these people. Persons of other companies, however, had been sold bonds during a recession period. These persons tried repeatedly to elect an "outsider" to the Board of Directors. Finally, they succeeded and Ireneus "Dutch" Creagan became a member of the cwc Board. "Dutch", a splendid fellow and great humorist, was the first Director not of the two parent companies.

At this time, because of his continuing efforts and his ability to keep people interested both in the construction of Willowbrook Country Club and in their payments for its golf course, William A. Ragan was given a life time fully paid membership in Willowbrook Country Club.

ASSESSMENTS cwc

For 1959 these assessments were made:

	For Capital Improvements	Maint- enance	Tax	Annual Total
Charter Member	60.00	30.00	6.00	96.00
Family of Charter Member	0.00	10.00	2.00	12.00

The additional payments for family participation was intentionally made small, so as to encourage this type of membership. Other participation was included for 1961: Social Charter \$42.00, Junior \$27.00, Male Golfing \$146.00 and Female Golfing \$54.00

WATERWORKS

A winding, woodland, two acre lake was engineered and constructed comprising:

180	Feet of breastwork 100 feet wide, 25 feet high
8 million	Gallons water capacity
1000	Feet shoreline
12	Foot wide water by-pass
10	Inch concrete drain line through breastwork

The water system requirements serving greens, tees and approaches were:

1600	Feet ditches
1600	Feet pipe - 1½ to 6 inches
44	Horsepower pump
12	Feet bowl assembly protrusion into lake
155	Pounds water pressure
350	Gallons of water per minute

For the fisherman, this beautiful lake site was stocked with fish. Alongside, a pleasant, child's playground, and family picnic area was prepared, with fire places, tables and benches.

Included in the water workings, a small lake was constructed in number three fairway, as a water hazard. This lake served as a water basin for the water shed areas and several springs.

BALANCE SHEET

In Spring, 1958, the member bond holders were asked to complete a pledge form showing how much they would attempt to pay in the year. Free drawing tickets for prizes were given those who contributed extra payments.

A fiscal balance sheet in 1958 showed, in round figures:

Income	\$59,000
Total expenses	\$56,000
Balance	\$3,000

Willowbrook Country Club was ambitiously scheduled for opening in the Spring of 1959, depending upon the works progress, which in turn was contingent upon the amount of money the treasury had to work with.

MIDNIGHT SLING

Willowbrook Country Club was short of development money. At a yearly business meeting, I got to my feet and delivered myself somewhat as follows:

"Our lower parking lot is clay, rocks and rivulets. Along the parkway there is a swelling mountain of slag residue. Doesn't this material set up in a reasonable fashion when in use as a pavement? Give me a dump truck, five men and Screech and I will pave the parking lot for you."

Screech got up, curious. "Why do you want me?"

"If the slag is for sale, we'll buy it," I said. "If it's free we'll load the truck a-plenty of times with it. If it's neither of those, we may have to swipe that slag after midnight, and we'll need your background."

Within three weeks the whole parking lot was well "paved" with about four inches of slag.

TWILIGHT

The mixed couples, nine hole golf event was running late. Finished couples awaited and viewed the play of following participants on the green of par 3, number nine hole. Circled above and around the green, the audience became scarcely visible in the twilight, as the players drove their golf balls off the 9 tee. The audience laughed as Shorty's drive landed somewhere out in the pine trees. Shorty's partner's ball landed off the green in "frog hair" grass, twenty five feet from the cup. To his delighted audience, Shorty indicated this shot was easy for him to make. He, whereupon, with a theatrical, great nonchalance, chipped the ball to within a foot from the hole. Great disbelief was evident from the reaction of his viewers.

Shorty, with a great smile, his white teeth gleaming, indicated, assuredly, that he could make that same, "frog hair" shot again, just as easily. Much laughter followed his acclamation of great expertise in the chip shot. Calmly, smiling, Shorty replaced his ball. The crowd quieted as he again surveyed the rub of the green. Head over the ball, his wedge lifted and struck! The ball raised into the air, bounced, rolled; and glancing off the pin in the cup, it stopped fourteen inches from the hole. The viewers exclaimed their great delight, as Shorty proudly accepted their praise.

Acceptably, because of the gathering darkness in this Chapman Event, the Professional Golfer declared all average scores were to be used for holes seven and eight, as the players were moved on to number 9 tee, to continue in the golf match. The Pro. brought large candles, and they were lighted encircling the green. He placed one lighted candle on top of the flag. As darkness drew on, with the players continuing, car headlights rimmed the 9 fairway. Flashlights gleamed to mark the play of balls.

Tables, chairs and benches appeared, as waitresses serve refreshments to the delighted viewers of Chapman Golf, encircling number 9 green. In the darkness with a pleasant iridescence of lighted candles, headlights below rimming the fairway, jack lights and flashlights in motion, the audience with great interest and jocularity followed the play on the green to the end of the couples event. Ralph and Brown Eyes declared their winning was a snap. They birdied number nine in the candlelight.



I'VE BEEN TELLIN'
THAT ONE SINCE
I CHIPPED A
SMILER WITH A
MASHIE NIBLICK

THE HARD CORE

Proposed Clubhouse
 Willowbrook Country Club
 August 20, 1957

- 1. Main Entrance
- 2. Lobby
- 3. Lounge
- 4. Bar
- 5. Dining Room
- 6. Kitchen
- 7. Pantry
- 8. Storage
- 9. Restrooms
- 10. Men's Locker Room
- 11. Women's Locker Room
- 12. Men's Shower
- 13. Women's Shower
- 14. Changing Room
- 15. Coat Room
- 16. Elevator
- 17. Staircase
- 18. Office
- 19. Reception
- 20. Smoking Area
- 21. Clubhouse
- 22. Terrace
- 23. Entrance
- 24. Terrace
- 25. Practice Putting Green

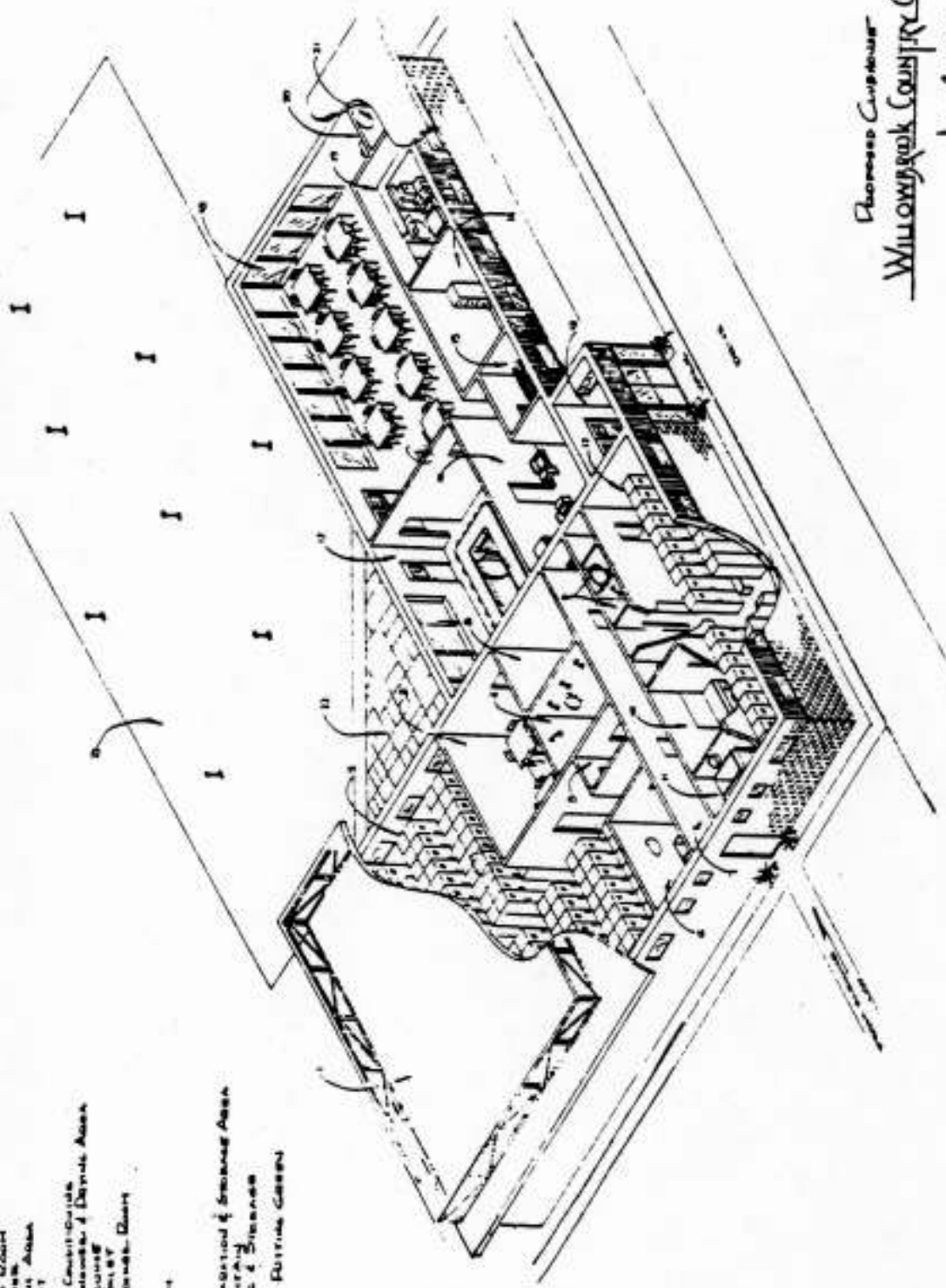

THE 1978 SM&E DEPT. INVITATIONAL GOLF MATCHES

Play Golf At

Willowbrook Country Club

Play For Prizes In

BEST 3 BALLS OF MYSTERY FOURSOME

Best Individual Net Score Wins The

Vice President's Cup



Play In Your Own Foursome, SM&E
Event. Or Your Committee Places
You in a Foursome

YOU ARE INVITED TO PLAY GOLF

at

Willowbrook

On Saturday, Sept. 9, 1978

Time 11:30 A.M.

Pay Entry Fee Now (Prizes) \$3.00

Pay Greens Fee at Club, \$10.00

No Caddy Is Required

Handicaps

Defender, W. R. Lydick

* * * * *
Fill Out Coupon and Send To

J. C. Elder, SM&E

EVER WIN A VP CUP?



FINESSE

WABCO US&S DIV.

SM&E JCE Aug. 9, 1978

HEADWAY

YOU KNOW, STEVE, IT'S NOT MY GAME THAT'S BAD! IT'S THIS COCKEYED GOLF COURSE OF YOURS THAT'S DOIN' IT! WHY, I'VE APPROACHED THREE DIFFERENT GREENS OUT OF THESE SAME, CONFOUNDED TREES!

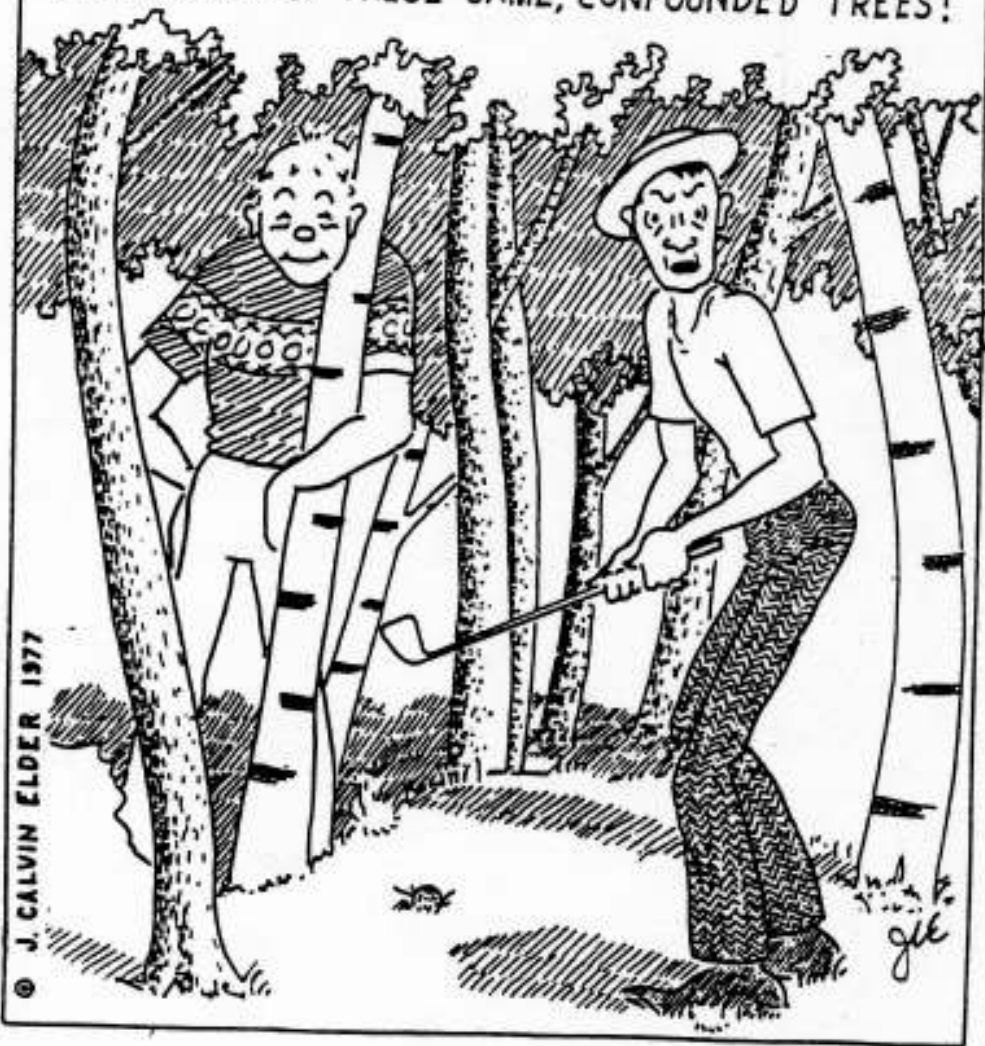

© J. CALVIN ELDER 1977

THE PUT PUTT

On my putting, beginning golf, I tried all manner and means of putting, exhaustively. Using my hands, only, to swing the putter shaft was the most accurate way. Once aimed, nothing can then change in the contact with the ball. It is tapped, not pushed. The arms and shoulders do not move. Only the wrists pivot. Correctly done, with the blade of the putter perpendicular to the line of flight of the ball, the results are certainly predictable, really, engineered.

FORTY DOLLARS

At one time during the construction of Willowbrook Country Club there came a recession period. It was a concern as to whether or not Willowbrook would become completed. I, myself, was in arrears forty dollars, or four months in bond payments. Myself, and others wanted cWc to be completed but we were uncertain as to whether or not it could be done. We talked to those who would know of the circumstances involved. I went to Bill Ragan's office.

"Bill, how is Willowbrook Country Club coming along?" I asked. "Is it going to be completed? What is our problem? I owe the organization forty dollars! What should I do?"

I, of course, knew the answer.

Bill Ragan looked me straight in the eye. "Cal, pay your forty dollars."

On the spot, I paid the forty dollars. I know that similar circumstance occurred with many of the interested people. The integrity of Willowbrook was maintained through their confidence in Bill Ragan.

HAIR CUT

The most useful technique in golfing, I learned in a barber's chair. A golfer, my barber was, himself, reminded of this when playing with a pro. relative. My barber repeated this gem of wisdom to me:

Take a slow, easy backswing. Pause momentarily! Then start your forward swing. The slight pause, after your backswing, inherently permits your hips to begin the forward rotation, first. You don't even have to think about it. This initial movement in the hips allows an action, through the lower legs and in body rotation, to become an ample whipping force in your club head. Furthermore, the slight pause after your backswing makes the club head stop moving, or waving. The forward swing then starts with the club head at rest. There exists no inertial force to cause the club head to first move either inwardly or outwardly in your swing.

ROOMS, ROOMS

The original bookkeeper's room of Willowbrook Country Club, near the front door and adjacent the kitchen, was moved to the former Pro. Shop area. The kitchen was enlarged by expanding into this available space. New kitchen equipment was purchased. A club manager was hired. The club president, directors, and sundry helpers converted the former golf clubs storage room into a member's room adjoining the bar room.

FAMILY DAY

Through the period of construction of Willowbrook Country Club and after its opening in 1960, since it was a Family Membership operation, the club had in each September a Family Day. Each bond holder brought his family to Willowbrook for this outing. There was popcorn, icecream, hamburgers, corn on the cob, pop, french fries, hot dogs, ham and eggs, baked potatoes, and plenty of beer. Everybody had a grand time. Included were clowns in full costume and painted faces to entertain the children, and adults, as well. There were many games for the children. The adults engaged in many games, as well, including best hole in one shot, farthest throw of a five iron, hay rides after dark, cards and good sociability. Not far from Willowbrook is a sky diving organization. Arrangements were always made that an airplane would buzz the members, racing into the area in a low, power dive. Then several parachutists dropped from the sky to land in a small circle nearby on number ten fairway.

INCIDENTALS

A proposition to complete a swimming pool at \$86,000, with its yearly assessment, was not favored by membership.

The good news in February, 1963, was that of receipt of the Licquor License. To obtain this license, the committee, through the past years, generally, visited every listed bar of the County, to establish that, of the total license availability and presumed useage, one such location no longer had an address.

Willowbrook's fairways are fairly level, with few side-, down-, or up-hill lies. As such, and being expansive, it has attracted many long-ball hitters.

The membership of the golf league which initiated the building of Willowbrook Country Club was eighty persons.

Maybe they'll bet on you!

J. CALVIN ELDER